



48TC 18,21,25,29 WEATHERMAKER® SERIES SINGLE PACKAGE ROOFTOP GAS HEATING/ELECTRIC COOLING HORIZONTAL AIR FLOW UNITS TWO-STAGE COOLING CAPACITY CONTROL

- PERFORMANCE DATA**
- CERTIFIED DIMENSION PRINTS**
- CERTIFIED ROOF CURB DETAILS**



JOB NAME:	LOCATION:	
BUYER:	BUYER PO #:	CARRIER#:
UNIT NUMBER:	MODEL NUMBER:	

PERFORMANCE DATA CERTIFIED BY:

DESCRIPTION

48TC (model sizes 18, 21, 25, 29) units are single-packaged dedicated horizontal air flow electric cooling, gas heating units that are pre-wired and pre-charged with Puron® (R-410A) HFC refrigerant. The units are factory tested in both heating and cooling modes. These units meet the ASHRAE (American Society of Heating, Refrigerating, and Air-Conditioning Engineers) 90.1-2016, DOE-2018 (Department of Energy), and IECC-2015 (International Energy Conservation Code) minimum efficiency requirements when equipped with the SAV™ (Staged Air Volume) option.

FEATURES

Standard Base Unit (United States Models)

- Puron (R-410A) HFC refrigerant
- Two-stage cooling capacity control on all models
- EERs up to 10.8
- IEERs up to 12.7 (includes SAV)
- Staged Air Volume (SAV™) fan speed system
- Designed in accordance with Underwriters Laboratories Standard 1995
- Listed by ETL and ETL-Canada
- DOE-2018, ASHRAE 90.1-2016 and IECC-2015 energy compliant
- Rated in accordance with AHRI Standard 340/360
- Non-corrosive composite sloping design; side or center drain condensate pan. Meets ASHRAE Standard 62
- Standard cooling operating range from 35°F up to 115°F (2°C up to 46°C)
- Dedicated horizontal airflow models. No special field kits required
- Two-inch disposable return air filters on slide out track
- Provisions for thru-the-bottom power entry capability as standard in an environmentally protected area
- Single point gas and electric connections
- 24-volt control circuit protected with resettable circuit breaker and 75-VA transformer
- Permanently lubricated evaporator-fan motor
- Blower bearing extend lubrication line on all sizes
- Totally enclosed condenser motors with permanently lubricated bearings
- Low-pressure and high-pressure switch protection
- Full perimeter base rail with built-in rigging adapters and fork truck slots
- Central terminal board facilitating simple safety circuit troubleshooting and simplified control box arrangement
- High performance belt drive motor with variable pitch pulleys, quick adjust belt system and fan belt protection

Standard Base Unit (Non-United States Models)

- All features listed above and:
 - EERs up to 10.8
 - IEERs up to 10.8 (without SAV)
 - IEERs up to 12.7 (with SAV)

Cabinet (All)

- Access panels with easy grip handles
- Innovative, easy starting, no-strip screw feature on unit access panels
- Pre-painted exterior panels and primer-coated interior panels tested to 500 hours salt spray protection
- Fully insulated cabinet

Refrigerant System (All)

- Acutrol™ refrigerant metering system
- Liquid line filter drier on each circuit
- Scroll compressors with internal line-break overload protection
- Copper tube, aluminum fin evaporator coil
- Round Tube/Plate Fin (RTPF) condenser coils on all model sizes or Novation® all aluminum condenser coils available on 17 to 28 sizes.

Gas Heat (All)

- Gas efficiencies up to 81%
- Induced draft combustion design
- Redundant gas valve, with up to 2 stages of heating
- Solid-state electronic direct spark ignition system
- Exclusive IGC anti-cycle protection for gas heat operation
- Flame roll-out safety protector

Standard Limited Parts Warranty (All)

- 15-year limited on all gas heat exchanger parts - Stainless Steel
- 10-year limited on all gas heat exchanger parts - Aluminized
- 5-year limited on all compressor parts
- 5-year on factory installed Ultra Low Leak Economizer parts
- 1-year limited on all parts

PERFORMANCE DATA

Unit Operating Weight _____ lb

Curb Weight _____ lb

COOLING (ELECTRIC)

HEATING (GAS)

Gross Total Capacity _____ Btuh

Heating Capacity:

at Condenser Air Temperature _____ °F

Stage 1 _____ Btuh

Gross Sensible Capacity _____ Btuh

Stage 2 _____ Btuh

Compressor Power Input _____ kW

Heating Capacity Total _____ Btuh

Indoor Entering: db _____ °F / wb _____ °F

Stage 1 _____ kW

Airflow _____ CFM External Static Pressure _____ in. wg

Stage 2 _____ kW

Indoor Fan Motor Size _____ HP

Heating Capacity Total _____ Btuh

Exhaust Fan Motor Size _____ HP

ELECTRICAL DATA

Power Supply to Unit _____

Volts _____

Phase _____ Hz

Maximum Circuit Amps _____

Maximum Overcurrent Protection _____

SUBMITTAL DATA

Job Name _____

Architect _____

Engineer _____

Contractor _____

Unit Designation _____



Use of the AHRI Certified TM Mark indicates a manufacturer's participation in the program For verification of certification for individual products, go to www.ahridirectory.org.

FACTORY-INSTALLED OPTIONS

□ Economizer with DRY BULB Sensing and Barometric Relief

Low Leak Air Dampers —

- Models with W7212 controller provide standard non-diagnostic control (EconoMiSer® IV system).
- Models with W7220 controller meet California Title 24 (Section 120.2) for Fault Detection and Diagnostic (FDD) requirements (EconoMiSer X system).
- Models with RTU Open controller meet California Title 24 (Section 120.2) Fault Detection and Diagnostic (FDD) requirements (EconoMiSer 2 system).
- Models with PremierLink™ controller. PremierLink controller does not meet California Title 24 (Section 120.2) Fault Detection and Diagnostic (FDD) requirement (EconoMiSer 2 system).

□ Economizer with ENTHALPY Sensing and Barometric Relief

Low Leak Air Dampers —

- Models with W7212 controller provide standard non-diagnostic control (EconoMiSer® IV system).
- Models with W7220 controller meet California Title 24 (Section 120.2) Fault Detection and Diagnostic (FDD) requirements (EconoMiSer X system).
- Models with RTU Open controller meet California Title 24 (Section 120.2) Fault Detection and Diagnostic (FDD) requirements (EconoMiSer 2 system).
- Models with PremierLink™ controller. PremierLink controller does not meet California Title 24 (Section 120.2) Fault Detection and Diagnostic (FDD) requirement (EconoMiSer 2 system).

□ Economizer with DRY BULB Sensing and Barometric Relief

ULTRA LOW LEAK Air Dampers —

- Models with W7220 controller meet California Energy Commission Title 24-2016 perspective section 140.4 (damper leakage, etc.), and mandatory section 120.2.i for Fault Detection and Diagnostic controls. Economizers meet ASHRAE 90.1-2016 damper leakage requirements as stated in section 6.5.1.1.4 and Table 6.4.3.4.3, and meet 2016 Fault Detection and Diagnosis requirements in section 6.4.3.12. For outside air, return, and relief air damper leakage requirements economizers meet IECC 2012 section C402.4.5.2 and, IECC 2015 sections C403.2.4.3 and C403.3.3.5 and IECC 2015 section C403.2.4.7 for Fault Detection and Diagnostic requirements.
NOTE: IECC 2015 section C403.2.4.7.1 requires differential return air sensor, which must be ordered separately.
Outside air, return air, and relief air (volume) dampers are AMCA rated — plus 5 year limited parts warranty (EconoMiSer X system).

- Models with RTU Open meet California Energy Commission Title 24-2016 perspective section 140.4 (damper leakage, etc.) and mandatory section 120.2.i for Fault Detection and Diagnostic requirements. Economizers meet ASHRAE 90.1-2016 damper leakage requirements as stated in section 6.5.1.1.4 and Table 6.4.3.4.3, and meet 2016 Fault Detection and Diagnosis requirements in section 6.4.3.12. Economizers meet IECC 2012 section C402.4.5.2 and, IECC 2015 sections C403.2.4.3 and C403.3.3.5 for outside air, return air, and relief air damper leakage requirements and IECC 2015 section C403.2.4.7 for Fault Detection and Diagnostic requirements.
NOTE: IECC 2015 section C403.2.4.7.1 requires differential return air sensor, which must be ordered separately.
Outside air, return air, and relief air (volume) dampers are AMCA rated — plus 5 year limited parts warranty (EconoMiSer 2 system).

□ Economizer with ENTHALPY Sensing and Barometric Relief

ULTRA LOW LEAK Air Dampers —

- Models with W7220 controller meet California Energy Commission Title 24-2016 perspective section 140.4 (damper leakage, etc.), and mandatory section 120.2.i for Fault Detection and Diagnostic controls. Economizers meet ASHRAE 90.1-2016 damper leakage requirements as stated in section 6.5.1.1.4 and Table 6.4.3.4.3, and meet 2016 Fault Detection and Diagnosis requirements in section 6.4.3.12. For outside air, return, and relief air damper leakage requirements economizers meet IECC 2012 section C402.4.5.2 and, IECC 2015 sections C403.2.4.3 and C403.3.3.5 and IECC 2015 section C403.2.4.7 for Fault Detection and Diagnostic requirements.
NOTE: IECC 2015 section C403.2.4.7.1 requires differential return air sensor, which must be ordered separately.
Outside air, return air, and relief air (volume) dampers are AMCA rated — plus 5 year limited parts warranty (EconoMiSer X system).
- Models with RTU Open meet California Energy Commission Title 24-2016 perspective section 140.4 (damper leakage, etc.) and mandatory section 120.2.i for Fault Detection and Diagnostic requirements. Economizers meet ASHRAE 90.1-2016 damper leakage requirements as stated in section 6.5.1.1.4 and Table 6.4.3.4.3, and meet 2016 Fault Detection and Diagnosis requirements in section 6.4.3.12. Economizers meet IECC 2012 section C402.4.5.2 and, IECC 2015 sections C403.2.4.3 and C403.3.3.5 for outside air, return air, and relief air damper leakage requirements and IECC 2015 section C403.2.4.7 for Fault Detection and Diagnostic requirements.
NOTE: IECC 2015 section C403.2.4.7.1 requires differential return air sensor, which must be ordered separately.
Outside air, return air, and relief air (volume) dampers are AMCA rated — plus 5 year limited parts warranty (EconoMiSer 2 system).

FACTORY-INSTALLED OPTIONS (CONT)

Standard Base Unit (United States Models)

- RTU Open multi-protocol controller communicates to BACnet*, Modbus††, LonWorks**, and Johnson N2 protocols.
- CCN Direct Digital Control (DDC) - Premier-Link™ controller††
- Stainless steel gas heat exchanger (includes tubes, vestibule plate and collector box)
- Humidi-MiZer® adaptive dehumidification system (RTPF condenser coil units only)
- Two-position motorized outdoor air damper††
- 25% manual outdoor air damper††
- Non-fused disconnect
- Powered 115-volt convenience outlet
- Non-powered 115-volt convenience outlet
- Medium and high static evaporator fan motor. Medium static indoor fan motor is standard on size 29 models.
- Return air smoke detector
- Supply air smoke detector

- CO₂ sensor
- Condenser hail guard-louvered style
- Special coating protection for evaporator and condenser coils
- Hinged access panels
- Condensate overflow switch

Standard Base Unit (Non-United States Models)

- Staged Air Volume (SAV™) system utilizes a Variable Frequency Drive (VFD) to automatically adjust the indoor fan motor for 2 speed indoor fan motor control. Conforms to ASHRAE 90.1-2016 Standard – section 6.4.3.10.b and IECC-2015.

Optional Warranties

- Complete unit parts only, up to 5 years
 - Complete unit parts and labor, up to 5 years
- Many other optional warranties are available. See the Commercial Start-Up and Optional Extended Warranty Price pages for further information.

* BACnet is a registered trademark of ASHRAE (American Society of Heating, Refrigerating and Air-Conditioning Engineers).

† Modbus is a registered trademark of Schneider Electric.

** LonWorks is a registered trademark of Echelon Corporation.

†† Not available with SAV 2-speed fan motor.

FIELD-INSTALLED ACCESSORIES

□ Economizer with DRY BULB Sensing and Barometric Relief

Standard Air Leak Dampers —

- Models with W7212 controller provide standard non-diagnostic control (EconoMiSer® IV system).
- Models with W7220 controller meet California Title 24-2016 Section 120.2.i for Fault Detection and Diagnostic (FDD) requirements (EconoMiSer X system).
- Models with RTU Open controller meet California Title 24-2016 Section 120.2.i Fault Detection and Diagnostic (FDD) requirements (EconoMiSer 2 system).
- Models with PremierLink™ controller. PremierLink controller does not meet California Title 24-2016 Section 120.2.i Fault Detection and Diagnostic (FDD) requirement (EconoMiSer 2 system).

□ Economizer with ENTHALPY Sensing and Barometric Relief

Standard Air Leak Dampers —

- Models with W7212 controller provide standard non-diagnostic control (EconoMiSer IV system).
- Models with W7220 controller meet California Title 24-2016 Section 120.2.i Fault Detection and Diagnostic (FDD) requirements (EconoMiSer X system).
- Models with RTU Open controller meet California Title 24-2016 Section 120.2.i Fault Detection and Diagnostic (FDD) requirements (EconoMiSer 2 system).
- Models with PremierLink controller. PremierLink controller does not meet California Title 24-2016 Section 120.2.i Fault Detection and Diagnostic (FDD) requirement (EconoMiSer 2 system).

□ Economizer with DRY BULB Sensing and Barometric Relief

ULTRA LOW LEAK Air Dampers —

- Models with W7220 controller meet California Energy Commission Title 24-2016 perspective section 140.4 (damper leakage, etc.), and mandatory section 120.2.i for Fault Detection and Diagnostic controls. Economizers meet ASHRAE 90.1-2016 damper leakage requirements as stated in section 6.5.1.1.4 and Table 6.4.3.4.3, and meet 2016 Fault Detection and Diagnosis requirements in section 6.4.3.12. For outside air, return, and relief air damper leakage requirements economizers meet IECC 2012 section C402.4.5.2 and, IECC 2015 sections C403.2.4.3 and C403.3.3.5 and IECC 2015 section C403.2.4.7 for Fault Detection and Diagnostic requirements.
NOTE: IECC 2015 section C403.2.4.7.1 requires differential return air sensor, which must be ordered separately.
Outside air, return air, and relief air (volume) dampers are AMCA rated (EconoMiSer X system).

- Models with RTU Open meet California Energy Commission Title 24-2016 perspective section 140.4 (damper leakage, etc.) and mandatory section 120.2.i for Fault Detection and Diagnostic requirements. Economizers meet ASHRAE 90.1-2016 damper leakage requirements as stated in section 6.5.1.1.4 and Table 6.4.3.4.3, and meet 2016 Fault Detection and Diagnosis requirements in section 6.4.3.12. Economizers meet IECC 2012 section C402.4.5.2 and, IECC 2015 sections C403.2.4.3 and C403.3.3.5 for outside air, return air, and relief air damper leakage requirements and IECC 2015 section C403.2.4.7 for Fault Detection and Diagnostic requirements.
NOTE: IECC 2015 section C403.2.4.7.1 requires differential return air sensor, which must be ordered separately.
Outside air, return air, and relief air (volume) dampers are AMCA rated.

□ Economizer with ENTHALPY Sensing and Barometric Relief

ULTRA LOW LEAK Air Dampers —

- Models with W7220 controller meet California Energy Commission Title 24-2016 perspective section 140.4 (damper leakage, etc.), and mandatory section 120.2.i for Fault Detection and Diagnostic controls. Economizers meet ASHRAE 90.1-2016 damper leakage requirements as stated in section 6.5.1.1.4 and Table 6.4.3.4.3, and meet 2016 Fault Detection and Diagnosis requirements in section 6.4.3.12. For outside air, return, and relief air damper leakage requirements economizers meet IECC 2012 section C402.4.5.2 and, IECC 2015 sections C403.2.4.3 and C403.3.3.5 and IECC 2015 section C403.2.4.7 for Fault Detection and Diagnostic requirements.
NOTE: IECC 2015 section C403.2.4.7.1 requires differential return air sensor, which must be ordered separately.
Outside air, return air, and relief air (volume) dampers are AMCA rated (EconoMiSer X system).
- Models with RTU Open meet California Energy Commission Title 24-2016 perspective section 140.4 (damper leakage, etc.) and mandatory section 120.2.i for Fault Detection and Diagnostic requirements. Economizers meet ASHRAE 90.1-2016 damper leakage requirements as stated in section 6.5.1.1.4 and Table 6.4.3.4.3, and meet 2016 Fault Detection and Diagnosis requirements in section 6.4.3.12. Economizers meet IECC 2012 section C402.4.5.2 and, IECC 2015 sections C403.2.4.3 and C403.3.3.5 for outside air, return air, and relief air damper leakage requirements and IECC 2015 section C403.2.4.7 for Fault Detection and Diagnostic requirements.
NOTE: IECC 2015 section C403.2.4.7.1 requires differential return air sensor, which must be ordered separately.
Outside air, return air, and relief air (volume) dampers are AMCA rated.

FIELD-INSTALLED ACCESSORIES (CONT)

- Display Kit for Variable Frequency Drive (VFD), Staged Air Volume System. Allows additional set up and diagnostics of the unit VFD controller. Can be unit mounted or used with any other compatible VFD model as a reusable device.
- Power exhaust — centrifugal fan design
- Two-position motorized outdoor air damper*
- Manual outside air damper 25%*
- Roof curb — 14 inch (356 mm) tall
- Roof curb — 24 inch (610 mm) tall
- Condenser hail guard — louvered style)
- Flue discharge deflector
- Liquid propane (LP) conversion kit
- High altitude conversion kit
- Phase monitor (loss of phase/phase reversal)
- Winter start kit, down to 25°F (-4°C)
- Low ambient head pressure controller, down to -20°F (-29°C)
- Time Guard II compressor anti-cycle protection
- Thermostats and sensors
- Non-powered 115-volt (20 amp) convenience outlet
- Horn/Strobe annunciator
- Return air smoke detector
- Supply air smoke detector

Economizer Sensors

- Single Dry bulb control
- Differential Dry bulb control
- Single enthalpy control
- Differential enthalpy control
- CO₂ — wall mounted
- CO₂ — duct mounted
- CO₂ — unit mounted

* Not available with SAV 2-speed fan motor.

CERTIFIED DIMENSION PRINT

 UNITED CARRIER
 P.O. BOX 4898
 FORT WORTH, TX 76101
 THESE DRAWINGS ARE THE PROPERTY OF UNITED CARRIER CORPORATION AND ARE TO BE USED ONLY FOR THE PROJECT AND LOCATION SPECIFICALLY IDENTIFIED HEREIN. PERMISSION IS GRANTED TO REPRODUCE THESE DRAWINGS FOR THE PROJECT AND LOCATION SPECIFICALLY IDENTIFIED HEREIN. PERMISSION IS NOT GRANTED TO REPRODUCE THESE DRAWINGS FOR ANY OTHER PROJECT OR LOCATION.

CONNECTION SIZES	
A	1 3/8" DIA [35] FIELD POWER SUPPLY KNOCKOUT
B	3" DIA [76] FIELD POWER SUPPLY KNOCKOUT
C	3 5/8" DIA [92] FIELD POWER SUPPLY KNOCKOUT
D	7/8" DIA [22] FIELD CONTROL WIRING HOLE
E	3/4" - 1/4 NPT CONDENSATE DRAIN
F	3/4" - 1/4 NPT GAS CONNECTION (NOT SHOWN)
G	7/8" DIA [22] FIELD CONTROL WIRING KNOCKOUT

- NOTES:
- DIMENSIONS ARE IN INCHES, DIMENSIONS IN [] ARE IN MILLIMETERS.
 - CENTER OF GRAVITY
 - DIRECTION OF AIR FLOW

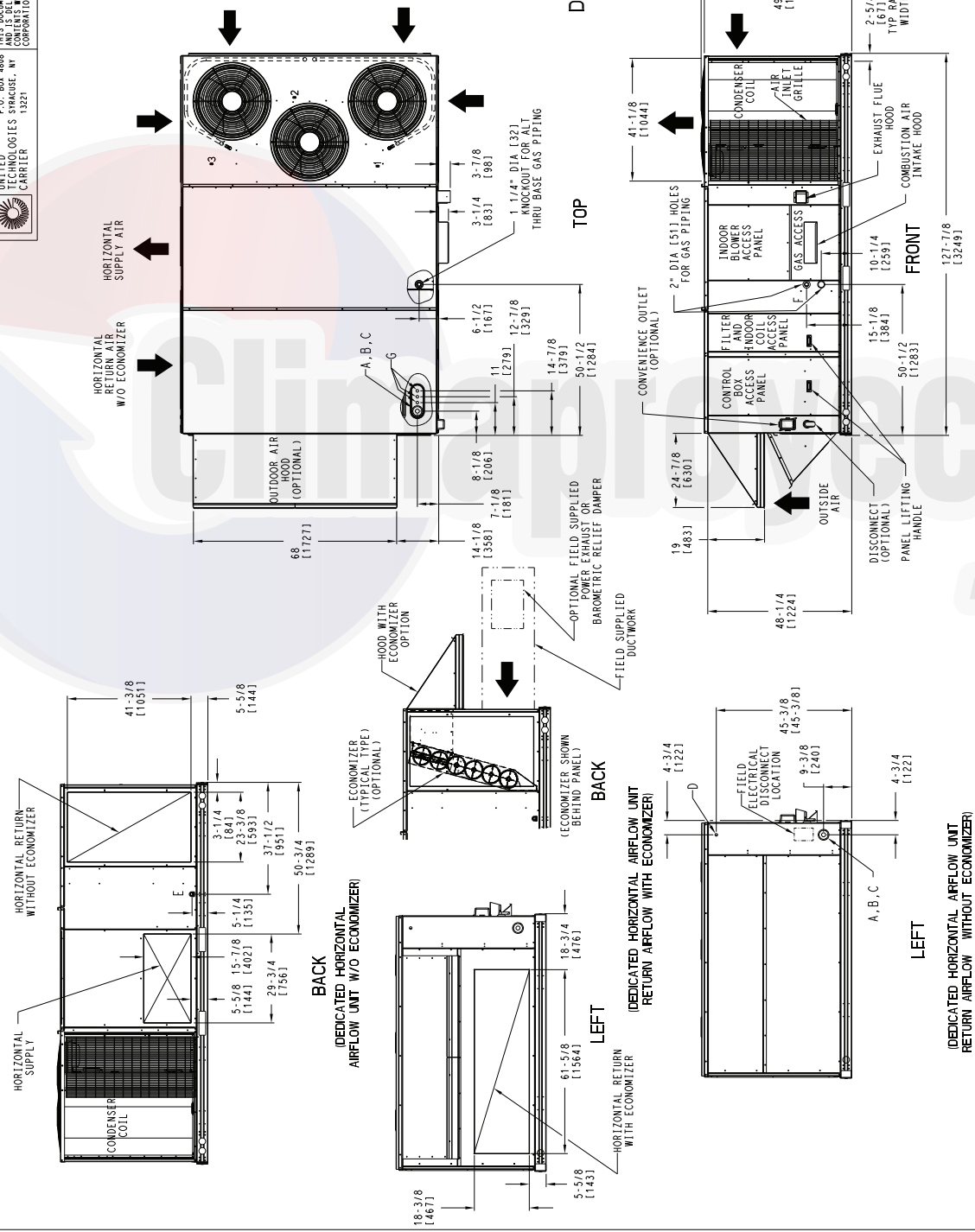

SHEET 2 OF 3	DATE 10/09/13	SUPERCEDES 10/26/10	48TC 17-20 SINGLE ZONE ELECTRICAL COOLING WITH GAS HEAT	50HE501150	REV D
-----------------	------------------	------------------------	---	------------	----------

Fig. 1 — 48TC18 Dimensional Drawing**

CERTIFIED DIMENSION PRINT

UNIT	STD UNIT WEIGHT *		CORNER WEIGHT (A)		CORNER WEIGHT (B)		CORNER WEIGHT (C)		CORNER WEIGHT (D)		C.G.								
	LBS.	KG.	LBS.	KG.	LBS.	KG.	LBS.	KG.	LBS.	KG.	X	Y	Z						
48TC17	1824	829	434	197	443	210	479	218	469	213	44	3/4	[1137]	64	3/4	[1645]	16	1/2	[419]
48TC20	1839	836	437	199	447	203	483	219	472	215	44	3/4	[1137]	64	3/4	[1645]	16	1/2	[419]
48TC17	1907	867	438	199	519	236	515	234	435	198	42	29/32	[1090]	69	1/4	[1759]	16	1/2	[419]
48TC18	1892	860	401	182	449	204	565	257	505	230	48	[1219]	67	3/8	[1711]	16	1/2	[419]	
48TC20	1922	874	441	201	523	238	519	236	438	199	42	29/32	[1090]	69	1/4	[1759]	16	1/2	[419]

* RTPE - ROUND TUBE PLATE FIN (COPPER/ALUM)
 MCHX - NOVATION (ALUM/ALUM)

* STANDARD UNIT WEIGHT IS WITH LOW GAS HEAT AND WITHOUT PACKAGING.
 FOR OTHER OPTIONS AND ACCESSORIES, REFER TO THE PRODUCT DATA CATALOG.

P. O. BOX 4868
 UNITED TECHNOLOGIES SPRINGHOUSE, NY 13221
 THIS DOCUMENT IS THE PROPERTY OF UNITED TECHNOLOGIES CORPORATION AND IS NOT TO BE REPRODUCED OR TRANSMITTED IN ANY FORM OR BY ANY MEANS, ELECTRONIC OR MECHANICAL, WITHOUT THE WRITTEN CONSENT OF UNITED TECHNOLOGIES CORPORATION.

SUBMISSION OF THESE DRAWINGS OR DOCUMENTS DOES NOT CONSTITUTE PART PERFORMANCE OR ACCEPTANCE OF CONTRACT.

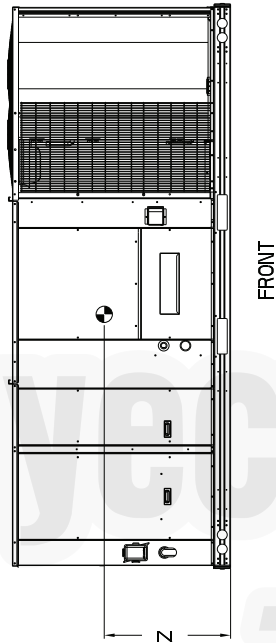
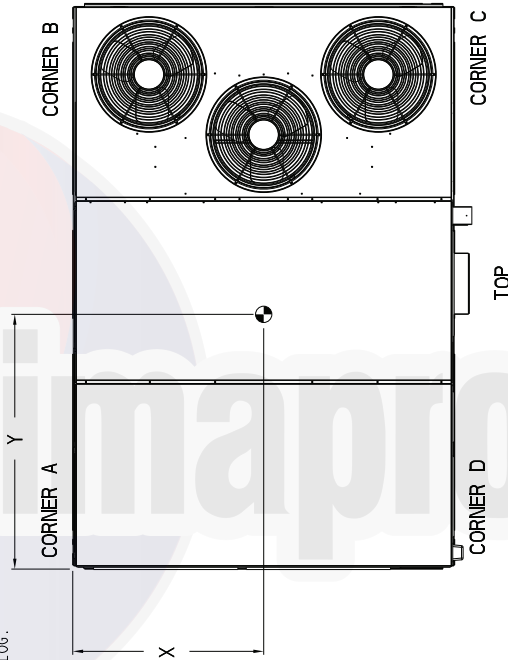

SHEET	DATE	SUPERCEDES	REV
3 OF 3	10/09/13	10/26/10	D

48TC 18 SINGLE ZONE ELECTRICAL COOLING WITH GAS HEAT 50HE501150

Fig. 2 — 48TC18 Corner Weights**

CERTIFIED DIMENSION PRINT



 P. O. BOX 4808
 UNITED TECHNOLOGIES SYPRAUSE, NY 13271
 CARRIER
 THIS DOCUMENT IS THE PROPERTY OF CARRIER CORPORATION. IT IS TO BE USED ONLY FOR THE SPECIFIC PROJECT AND NOT BE REPRODUCED, COPIED, OR DISSEMINATED WITHOUT CARRIER CORPORATION'S WRITTEN CONSENT.
 SUBMISSION OF THESE DRAWINGS OR DOCUMENTS DOES NOT CONSTITUTE PART PERFORMANCE OR ACCEPTANCE OF CONTRACT.

UNIT	OUTDOOR COIL TYPE	STD UNIT WEIGHT *		CORNER WEIGHT (A)		CORNER WEIGHT (B)		CORNER WEIGHT (C)		CORNER WEIGHT (D)		C. G.								
		LBS.	KG.	LBS.	KG.	LBS.	KG.	LBS.	KG.	LBS.	KG.	X	Y	Z						
48TC24	MCHX	1989	904	383	174	540	245	623	283	442	201	46	11/8	1117/2	82	7/8	210/5	16	1/2	41/9
48TC28	MCHX	2118	963	408	186	575	261	664	302	471	214	46	11/8	1117/2	82	7/8	210/5	19	1/2	48/3
48TC21	RTPF	2102	956	474	215	390	177	593	269	582	265	47	1/2	1120/1	71	1/4	181/0	16	1/2	41/9
48TC24	RTPF	2072	942	538	254	548	249	479	217	487	221	40	5/32	11020/1	70	17/8	1177/8	16	1/2	41/9
48TC25	RTPF	2247	1021	540	246	556	253	598	272	581	264	44	5/8	11133/1	71	5/8	1181/9	19	1/2	48/3
48TC28	RTPF	2197	999	571	259	564	256	528	240	534	243	41	21/32	11058/1	70	1/4	11784/1	19	1/2	48/3

* STANDARD UNIT WEIGHT IS WITH LOW GAS HEAT AND WITHOUT PACKAGING. FOR OTHER OPTIONS AND ACCESSORIES, REFER TO THE PRODUCT DATA CATALOG.

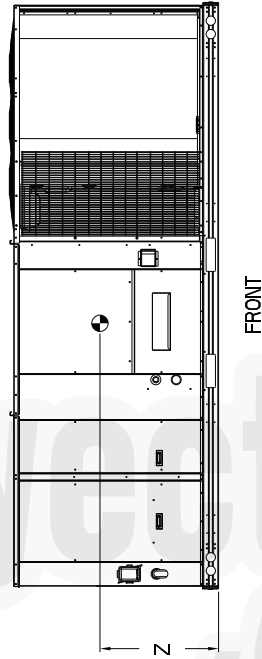
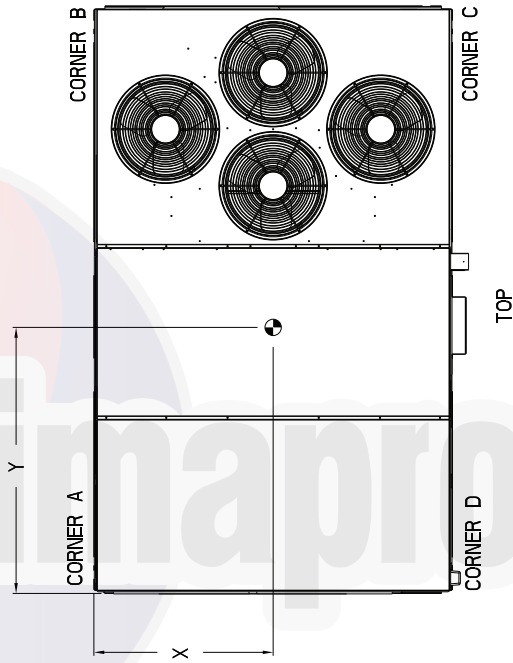

SHEET	DATE	SUPERCODES	48TC 21.25 SINGLE ZONE ELECTRICAL COOLING WITH GAS HEAT	REV
3 OF 3	10/09/13	10/26/10	50HE501158	D

Fig. 4 — 48TC**21 and 25 Corner Weights

CERTIFIED DIMENSION PRINT

UNIT	STD. UNIT WEIGHT *		CORNER WEIGHT (A)		CORNER WEIGHT (B)		CORNER WEIGHT (C)		CORNER WEIGHT (D)		C. G.					
	LBS.	KG.	LBS.	KG.	LBS.	KG.	LBS.	KG.	LBS.	KG.	X	Y	Z			
48TC29	2292	1042	577	262	559	254	583	265	602	274	44	[1118]	77 1/2	[1969]	19	[483]
48TC30	2640	1200	697	317	595	270	621	282	728	331	44	[1118]	72 1/2	[1842]	19	[483]

* STANDARD UNIT WEIGHT IS WITH LOW GAS HEAT AND WITHOUT PACKAGING.
 FOR OTHER OPTIONS AND ACCESSORIES, REFER TO THE PRODUCT DATA CATALOG.

 UNITED TECHNOLOGIES SFRASCISE, NY 13221
 P.O. BOX 4888
 CARRIER

THIS DOCUMENT IS THE PROPERTY OF CARRIER CORPORATION
 CONTENTS WILL NOT BE DISCLOSED OR USED WITHOUT CARRIER CORPORATION'S WRITTEN CONSENT.

SUBMISSION OF THESE DRAWINGS OR DOCUMENTS
 DOES NOT CONSTITUTE PART PERFORMANCE OR
 ACCEPTANCE OF CONTRACT.

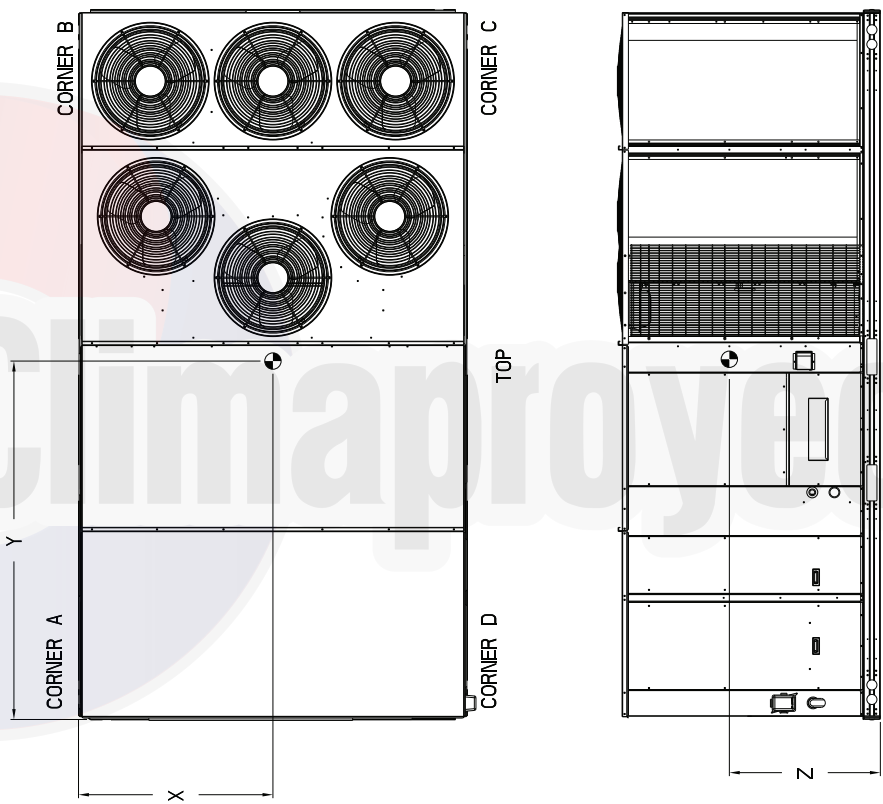

SHEET 3 OF 3	DATE 10/09/13	SUPERCEDES 05/19/11	48TC 29 SINGLE ZONE ELECTRICAL COOLING WITH GAS HEAT	50HE502174	REV B
-----------------	------------------	------------------------	---	------------	----------

Fig. 6 — 48TC29 Corner Weights**

CERTIFIED ROOF CURB DETAILS

UNIT SIZE	"A"	ROOF CURB ACCESSORY
18	1'-2" [356.0]	CRRFCURB045A00
	2'-0" [610.0]	CRRFCURB046A00

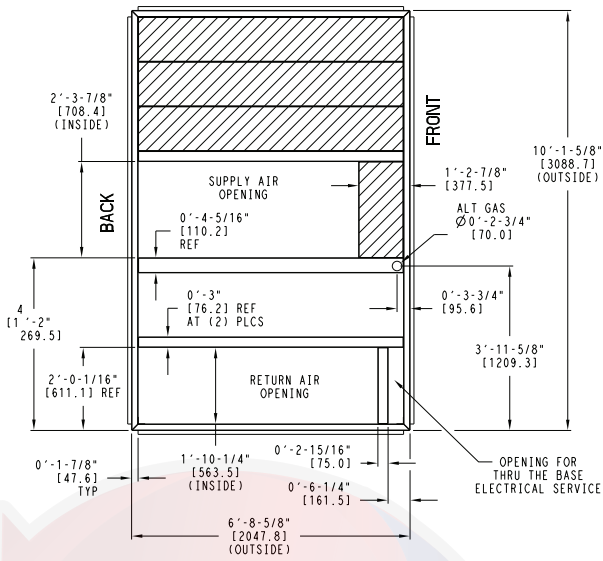

NOTES:

- 1 ROOF CURB ACCESSORY IS SHIPPED UNASSEMBLED.
- 2 DIMENSIONS IN [] ARE IN MILLIMETERS.
- 3 ROOF CURB GALVANIZED STEEL.
- 4 ATTACH DUCTWORK TO CURB (FLANGES ON DUCT REST ON CURB)
- 5 SERVICE CLEARANCE 4 FT ON EACH SIDE

➔ DIRECTION OF AIR FLOW

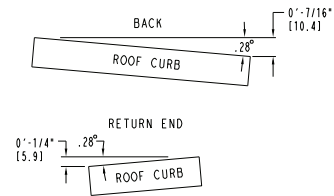

MAX CURB LEVELING TOLERANCES

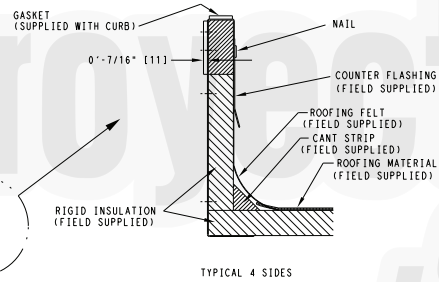
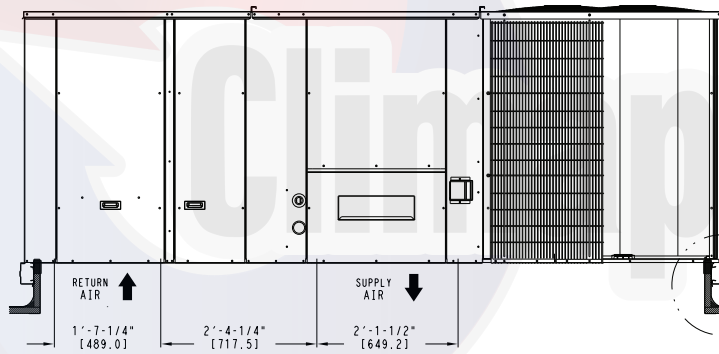

TYPICAL 4 SIDES

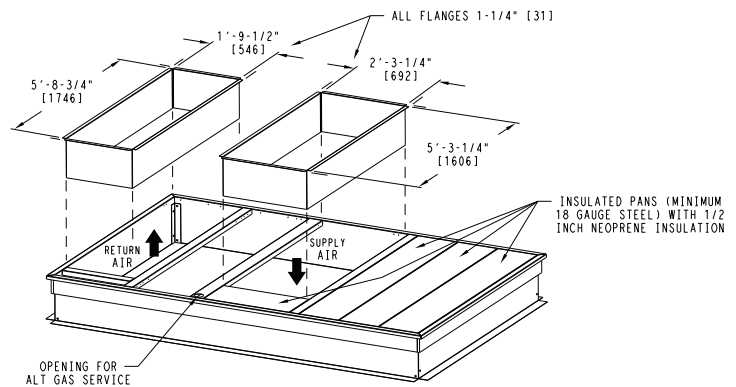
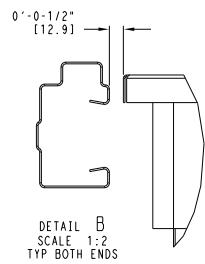
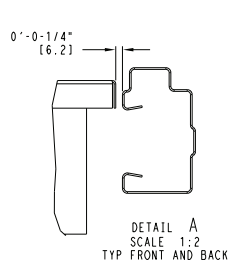
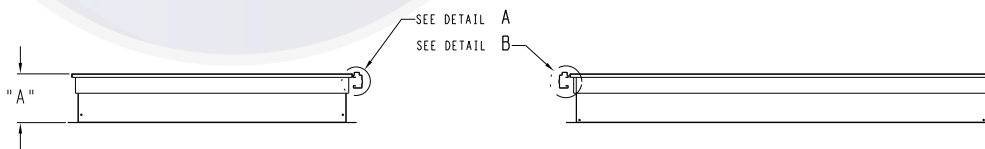
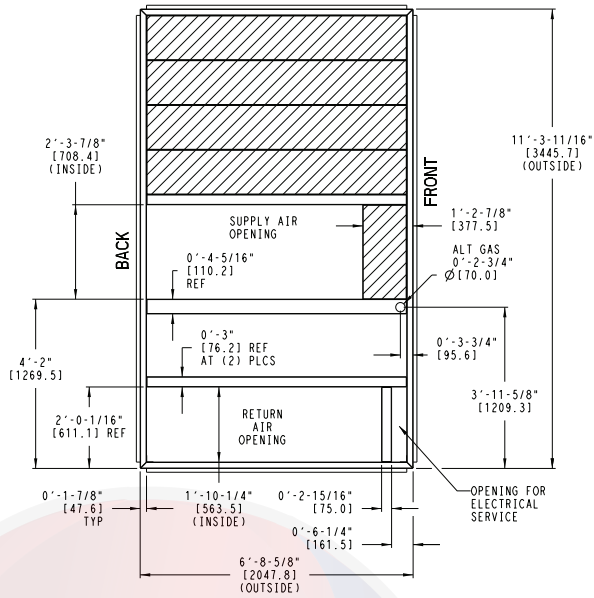

Fig. 7 — 48TC**18 Roof Curb Details

CERTIFIED ROOF CURB DETAILS

UNIT SIZE	"A"	ROOF CURB ACCESSORY
21, 25	1'-2" [356.0] 2'-0" [610.0]	CRRFCURB047A00 CRRFCURB048A00



NOTES:

- 1 ROOF CURB ACCESSORY IS SHIPPED UNASSEMBLED.
- 2 DIMENSIONS IN [] ARE IN MILLIMETERS.
- 3 ROOF CURB GALVANIZED STEEL.
- 4 ATTACH DUCTWORK TO CURB (FLANGES ON DUCT REST ON CURB)
- 5 SERVICE CLEARANCE 4 FT ON EACH SIDE

➔ DIRECTION OF AIR FLOW

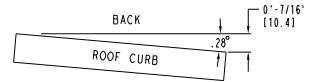

MAX CURB LEVELING TOLERANCES

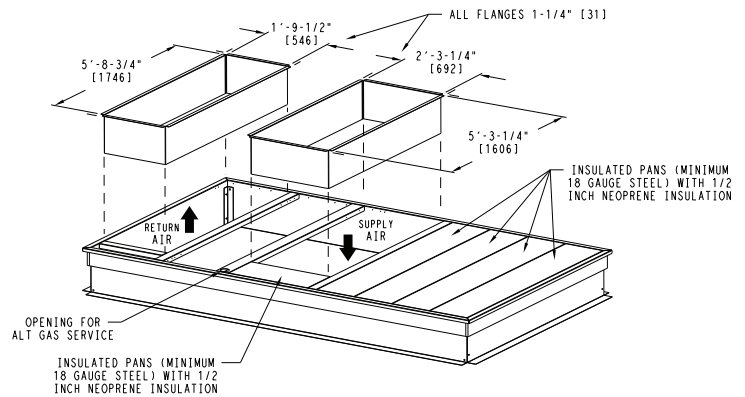
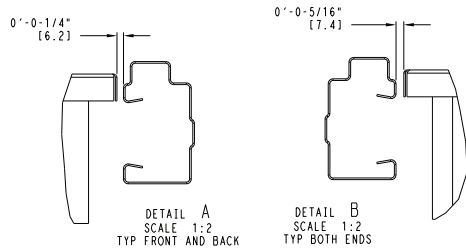
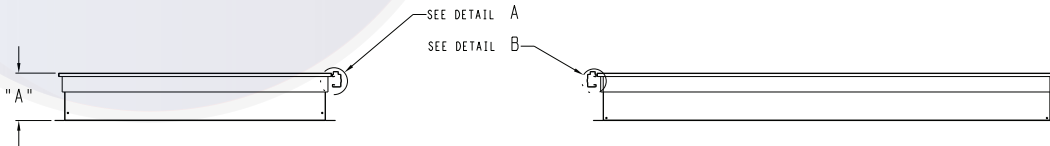
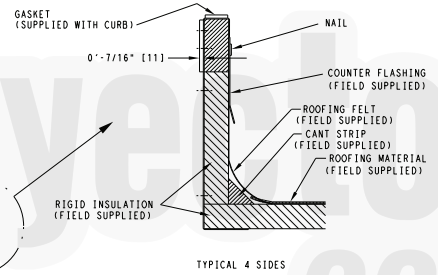
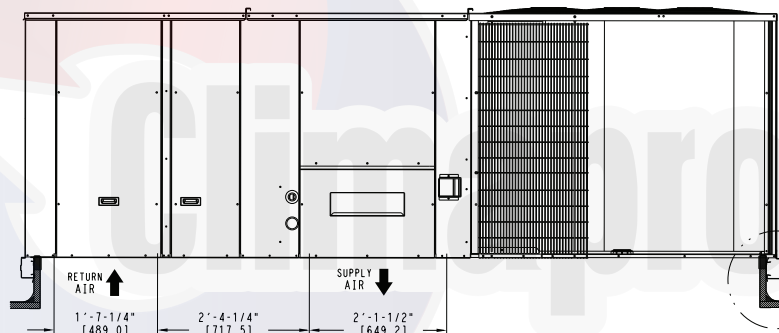
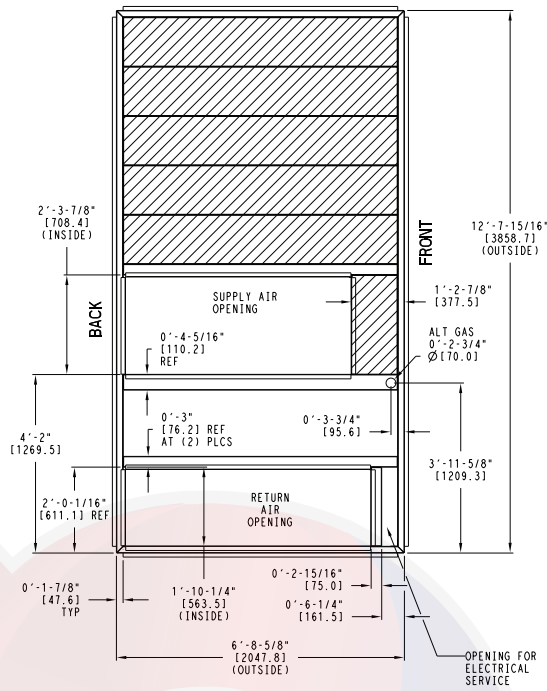

Fig. 8 — 48TC**21 and 25 Roof Curb Details

CERTIFIED ROOF CURB DETAILS

UNIT SIZE	"A"	ROOF CURB ACCESSORY
29	1'-2" [356.0] 2'-0" [610.0]	CRRFCURB049A00 CRRFCURB050A00



- NOTES:
- 1 ROOF CURB ACCESSORY IS SHIPPED UNASSEMBLED.
 - 2 BOLT HEADS TO BE ON INSIDE OF FLANGE. CLEARANCE IS (11) 0'-0-7/16" TYP ALL CORNERS.
 - 3 DIMENSIONS IN [] ARE IN MILLIMETERS.
 - 4 ROOF CURB GALVANIZED STEEL.
 - 5 ATTACH DUCTWORK TO CURB (FLANGES ON DUCT REST ON CURB)
 - 6 SERVICE CLEARANCE 4 IN ON EACH SIDE
 - 7 GAS SERVICE PLATE IS PART OF A SEPARATELY SHIPPED ACCESSORY PACKAGE.
 - 8 GAS SERVICE PLATE CAN BE USED WITH EITHER ACCESSORY ROOFCURB.

➔ DIRECTION OF AIR FLOW

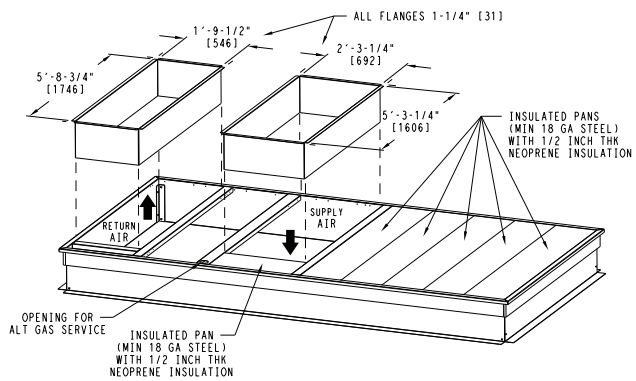
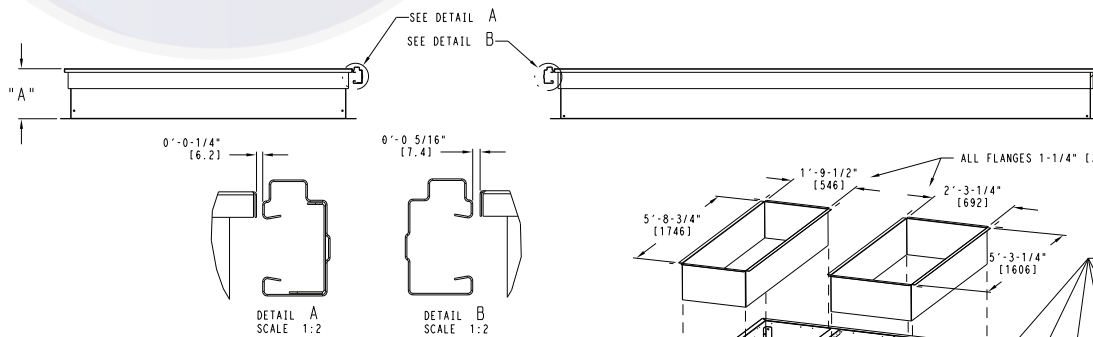
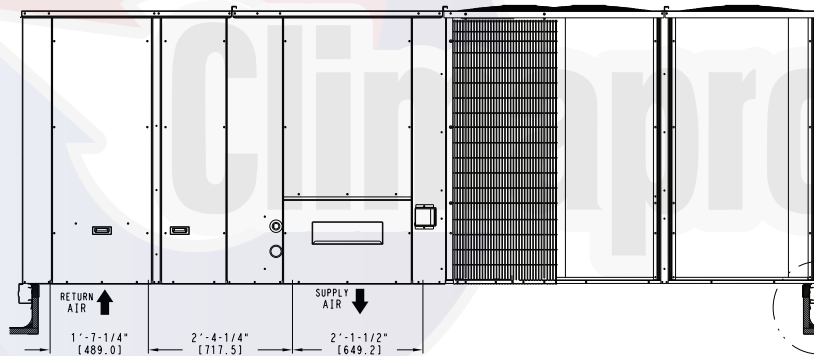
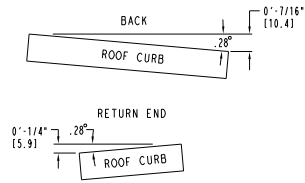

Fig. 9 — 48TC**29 Roof Curb Details